

WPS-4000-8

High-Power Voice and Siren System

Whelen's WPS-4000 Series High-Power Voice and Siren Systems deliver clear and powerful voice and siren communication.

Speaker Assembly:

WPS-4000-8 Speaker with eight speaker cells active, heavy duty cast aluminum rotor, 50' speaker and rotor control cable and pole top mounting bracket.

Electronics Cabinet:

Two compartment, natural finish aluminum Type III case.

Upper compartment: Eight Power Amplifiers, 2 System Motherboards; Power Supply; ESC-864 Electronic Siren Controller with integral timer, tone generator, local controls and microphone jack; rotor relay control; battery switch and temperature compensated battery charger.

Lower compartment: four heavy duty lead calcium batteries and battery tray.

FEATURES

- 130dBc @ 100'.
- 6,400' Estimated 70dB Warning Perimeter.
- Six Warning Tones.
- Public Address.
- Speaker Positioning for Voice Announcements.
- Battery Powered with AC Battery Charger.
- Local or Remote Control.
- Rugged Cast Aluminum Rotor.
- Eight High Efficiency 400 Watt Speaker Drivers. (One Per High Gain, Radial Horn).

OPTIONS

- Diagnostic Silent Test (SI TEST®).
- Remote Station Status Monitoring, COMM/STAT™.
- Environmental Monitoring/Status Reporting
- Pre-recorded Digital Voice Messages
- Solar Power

ACOUSTIC PERFORMANCE

SPL @ 100': 130dBc

Note: 100' performance levels listed represent repeatable results within +/- 2dB to stated levels. Estimated 70 dB perimeter is based on the Federal Emergency Management Agency's (FEMA) -10dB per distance doubled path model.

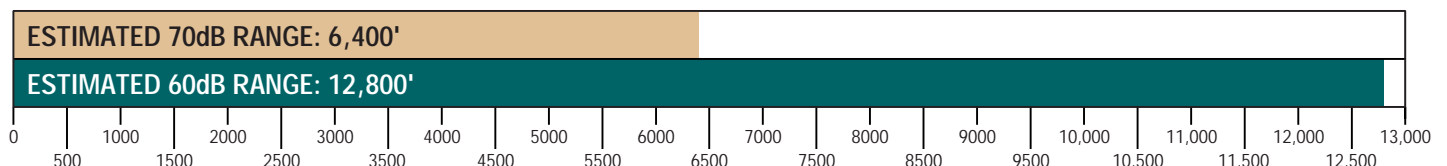

WPS-4000-8

Specification Data

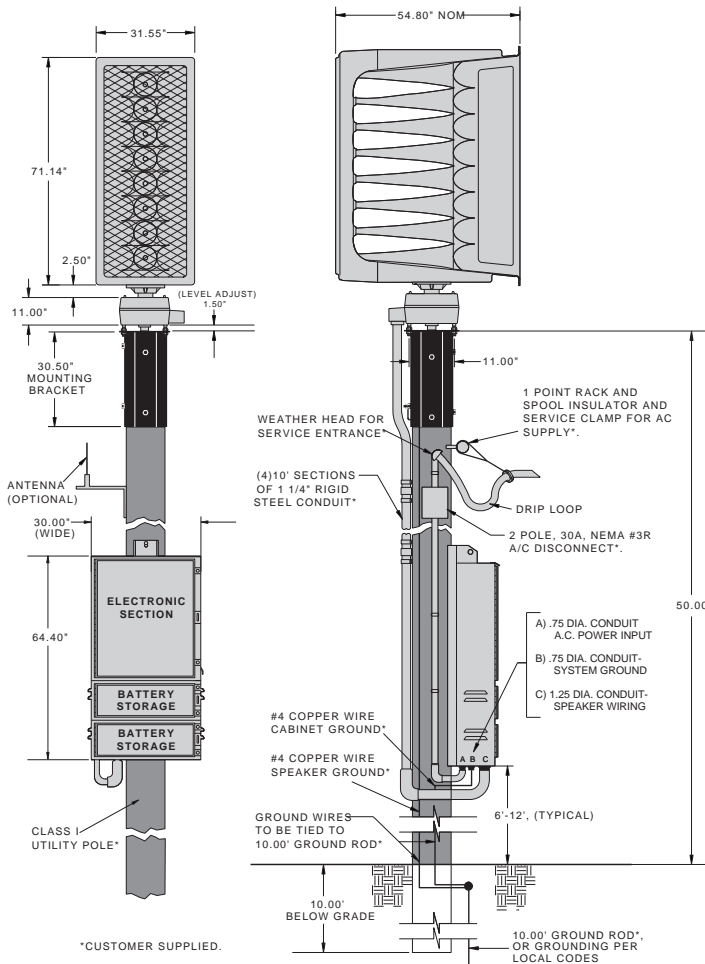

POLE TOP BRACKET

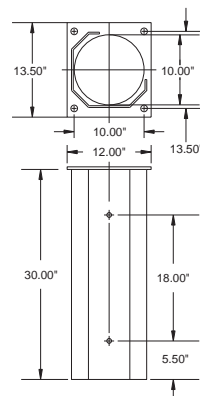

Route 145, Winthrop Road
 Chester, Connecticut 06412-0684
 (860) 526-9504
 1-800-63SIREN
 Fax: (860) 526-4784
 Internet: www.whelen.com

Whelen Engineering Company, Inc. reserves the right to upgrade its products with design improvements without notification. ©1997 Whelen Engineering Company, Inc. Printed in the U.S.A. 111497-WPS40004-10567B



ENVIRONMENTAL

Battery Charger Input: 120VAC, 60 HZ, 5a fuse
 Battery Charger Output: 10a
 Batteries: 4-12V, 105ah lead calcium
 Standby Current: 135ma, 24VDC
 Operating Current: 184a, 24VDC
 Power Amplifier Output Power:
 Siren: 3200 Watts, Voice: 4000 Watts

ENVIRONMENTAL

Operating Temperature: -35° C to +60° C.
 Storage Temperature: -65° C to +125° C.
 Humidity, Non condensing: 0 to 95%.

ORDERING INFORMATION

Basic System: WPS-4000-8

Basic System Options:

- STP-666A - Diagnostic Silent Test, SI TEST®
- RDVM - Remote Station Digital Voice¹

COMPONENT	HEIGHT Inches (CM)	WIDTH Inches (CM)	DEPTH Inches (CM)	WEIGHT LBS. (KG)
WPS-4000-8 SPEAKER	84.64 (215.0)	31.55 (80.1)	54.80 (139.2)	500 (227.3)
ELECTRONIC CABINET TYPE III	60.40 (164)	30.00 (76)	10.0 (25.4)	440 (200.00)
POLE TOP BRACKET	30.0 (76)	12.00 (30.5)	10.00 (25.4)	71 (32)

- D86410, D864L10, D864H10, D864U10 - One-Way Radio Control²
- C86410, C864L10, C864H10, C864U10 - Two-Way Radio Control / Status Monitoring, COMM/STAT™²
- CTCSS-R - Tone Squelch, Receive
- CTCSS-RT - Tone Squelch, Receive and Transmit
- INTRUIII - Intrusion Alarm
- LBALARM - Low Battery Alarm
- SBC-2/40, SBC-2/60 - Solar Power³

NOTES

1. 1-16 messages available. Available message lengths: 15, 30 or 60 seconds
2. Whelen 864 Series Radio Controls. Available frequencies: VHF Low Band (V-L) 30-50 Mhz, VHF High Band (V-H) 150-170 Mhz, UHF (U) 450-470 Mhz
 VHF Low Band systems equipped with a unity gain antenna. VHF High Band and UHF systems equipped with 2-3dB gain omni-directional antenna. 35' RG58 antenna cable and antenna mounting bracket included.
3. Solar power option includes 2-40 watt or 60 watt panels, mounting bracket and regulator.